

# ANSI B16.5 Class 900 Weld-Neck Flanges

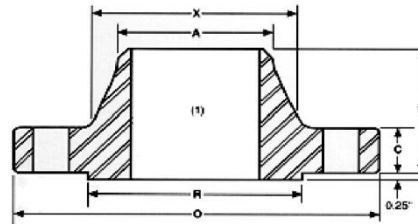

Nominal Size	Outside Diameter O	Thickness C	Dia Of Raised Face R	Dia. Of Hub At Base X	Dia. Of Hub at welding Point A	Length Thru Hub Y	No. Of Holes	Dia. of holes	Dia. Of Bolts	Dia. Of Bolt Circle	Approx. Weight (Lbs)
1/2"	4.75	0.88	1.38	1.50	0.84	2.38	4	0.88	3/4	3.25	5
3/4"	5.12	1.00	1.69	1.75	1.05	2.75	4	0.88	3/4	3.50	6
1"	5.88	1.12	2.00	2.06	1.32	2.88	4	1.00	7/8	4.00	9
1 1/4"	6.25	1.12	2.50	2.50	1.66	2.88	4	1.00	7/8	4.38	10
1 1/2"	7.00	1.25	2.88	2.75	1.90	3.25	4	1.12	1	4.88	13
2"	8.50	1.50	3.62	4.12	2.38	4.00	8	1.00	7/8	6.50	25
2 1/2"	9.62	1.62	4.12	4.88	2.88	4.12	8	1.12	1	7.50	36
3"	9.50	1.50	5.00	5.00	3.50	4.00	8	1.00	7/8	7.50	31
4"	11.50	1.75	6.19	6.25	4.50	4.50	8	1.25	1 1/8	9.25	53
5"	13.75	2.00	7.31	7.50	5.56	5.00	8	1.38	1 1/4	11.00	86
6"	15.00	2.19	8.50	9.25	6.63	5.50	12	1.25	1 1/8	12.50	110
8"	18.50	2.50	10.62	11.75	8.63	6.38	12	1.50	1 3/8	15.50	175
10"	21.50	2.75	12.75	14.50	10.75	7.25	16	1.50	1 3/8	18.50	260
12"	24.00	3.12	15.00	16.50	12.75	7.88	20	1.50	1 3/8	21.00	325
14"	25.25	3.38	16.25	17.75	14.00	8.38	20	1.62	1 1/2	22.00	400
16"	27.75	3.50	18.50	20.00	16.00	8.50	20	1.75	1 5/8	24.25	495
18"	31.00	4.00	21.00	22.25	18.00	9.00	20	2.00	1 7/8	27.00	680
20"	33.75	4.25	23.00	24.50	20.00	9.75	20	2.12	2	29.50	830
24"	41.00	5.50	27.25	29.50	24.00	11.50	20	2.62	2 1/2	35.50	1500

## TECH TUBES & FITTINGS

Phone: +91-22-6743 6862 ; Email: [sales@techtubes.in](mailto:sales@techtubes.in) ; Web: [www.techtubes.in](http://www.techtubes.in)

Information in this catalog was compiled from industry sources that Tech Tubes & Fitting believes to be reliable.

We, however, do not guarantee the accuracy of this data.

ALL DIMENSIONS IN INCHES