

# ANSI B16.5 Class 600 Blind Flanges

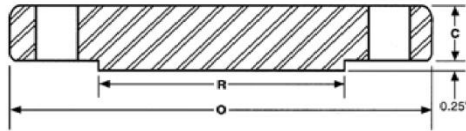

Nominal Size	Outside Diameter <b>O</b>	Thickness <b>C</b>	Dia Of Raised Face <b>R</b>	No. Of Holes	Dia. Of Holes	Dia. Of Bolts	Bolt Circle Diameter	Approx. Weight (Lbs)
1/2"	3.75	0.56	1.38	4	0.63	0.50	2.62	2
3/4"	4.63	0.63	1.69	4	0.75	0.63	3.25	3
1"	4.88	0.69	2.00	4	0.75	0.63	3.50	4
1 1/4"	5.25	0.81	2.50	4	0.75	0.63	3.88	5
1 1/2"	6.13	0.88	2.88	4	0.88	0.75	4.50	8
2"	6.50	1.00	3.63	8	0.75	0.63	5.00	10
2 1/2"	7.50	1.13	4.13	8	0.88	0.75	5.88	15
3"	8.25	1.25	5.00	8	0.88	0.75	6.62	20
3 1/2"	9.00	1.38	5.50	8	1.00	0.88	7.25	29
4"	10.75	1.50	6.19	8	1.00	0.88	8.50	41
5"	13.00	1.75	7.31	8	1.12	1.00	10.50	68
6"	14.00	1.88	8.50	12	1.12	1.00	11.50	86
8"	16.50	2.19	10.63	12	1.25	1.13	13.75	140
10"	20.00	2.50	12.75	16	1.38	1.25	17.00	230
12"	22.00	2.63	15.00	20	1.38	1.25	19.25	295
14"	23.75	2.75	16.25	20	1.50	1.38	20.75	355
16"	27.00	3.00	18.50	20	1.62	1.50	23.75	495
18"	29.25	3.25	21.00	20	1.75	1.63	25.75	630
20"	32.00	3.50	23.00	24	1.75	1.63	28.50	810
24"	37.00	4.00	27.25	24	2.00	1.88	33.00	1250

## TECH TUBES & FITTINGS

Phone: +91-22-6743 6862 ; Email: [sales@techtubes.in](mailto:sales@techtubes.in) ; Web:

[www.techtubes.in](http://www.techtubes.in)

Information in this catalog was compiled from industry sources that Tech Tubes & Fitting believes to be reliable.

We, however, do not guarantee the accuracy of this data.

**ALL DIMENSIONS IN INCHES**