

ANSI B16.5 Class 400 Slip-On Flanges

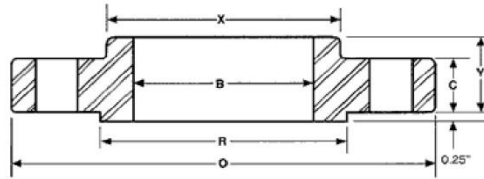

Nominal Size	Outside Diameter O	Thickness C	Dia Of Raised Face R	Dia. Of Hub At Base X	Length Thru Hub Y	Inside Diameter B	No. Of Holes	Dia. of holes	Dia. Of Bolts	Dia. Of Bolt Circle	Approx. Weight (Lbs)
1/2"	3.75	0.56	1.38	1.50	0.88	0.88	4	0.62	1/2	2.62	2
3/4"	4.62	0.62	1.69	1.88	1.00	1.09	4	0.75	5/8	3.25	3
1"	4.88	0.69	2.00	2.12	1.06	1.36	4	0.75	5/8	3.50	4
1 1/4"	5.25	0.81	2.50	2.50	1.12	1.70	4	0.75	5/8	3.88	5
1 1/2"	6.12	0.88	2.88	2.75	1.25	1.95	4	0.88	3/4	4.50	7
2"	6.50	1.00	3.62	3.31	1.44	2.44	8	0.75	5/8	5.00	9
2 1/2"	7.50	1.12	4.12	3.94	1.62	2.94	8	0.88	3/4	5.88	13
3"	8.25	1.25	5.00	4.62	1.81	3.57	8	0.88	3/4	6.62	16
3 1/2"	9.00	1.38	5.50	5.25	1.94	4.07	8	1.00	7/8	7.25	21
4"	10.00	1.38	6.19	5.75	2.00	4.57	8	1.00	7/8	7.88	26
5"	11.00	1.50	7.31	7.00	2.12	5.66	8	1.00	7/8	9.25	31
6"	12.50	1.62	8.50	8.12	2.25	6.72	12	1.00	7/8	10.62	44
8"	15.00	1.88	10.62	10.25	2.69	8.72	12	1.12	1	13.00	67
10"	17.50	2.12	12.75	12.62	2.88	10.88	16	1.25	1 1/8	15.25	91
12"	20.50	2.25	15.00	14.75	3.12	12.88	16	1.38	1 1/4	17.75	130
14"	23.00	2.38	16.25	16.75	3.31	14.14	20	1.38	1 1/4	20.25	180
16"	25.50	2.50	18.50	19.00	3.69	16.16	20	1.50	1 3/8	22.50	235
18"	28.00	2.62	21.00	21.00	3.88	18.18	24	1.50	1 3/8	24.75	285
20"	30.50	2.75	23.00	23.12	4.00	20.20	24	1.62	1 1/2	27.00	345
24"	36.00	3.00	27.25	27.62	4.50	24.25	24	1.88	1 3/4	32.00	510

TECH TUBES & FITTINGS

Phone: +91-22-67436862 ; Email: sales@techtubes.in ; Web: www.techtubes.in

Information in this catalog was compiled from industry sources that Tech Tubes & Fitting believes to be reliable.

We, however, do not guarantee the accuracy of this data.

ALL DIMENSIONS IN INCHES