

# ANSI B16.5 Class 300 Weld-Neck Flanges

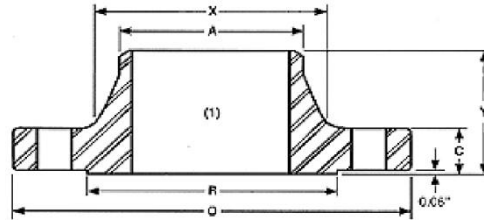

Nominal Size	Outside Diameter O	Thickness C	Dia Of Raised Face R	Dia. Of Hub At Base X	Dia. Of Hub at welding Point A	Length Thru Hub Y	No. Of Holes	Dia. of holes	Dia. Of Bolts	Dia. Of Bolt Circle	Approx. Weight (Lbs)
1/2"	3.75	0.56	1.38	1.50	0.84	2.06	4	0.62	1/2	2.62	2
3/4"	4.62	0.62	1.69	1.88	1.05	2.25	4	0.75	5/8	3.25	3
1"	4.88	0.69	2.00	2.12	1.32	2.44	4	0.75	5/8	3.50	4
1 1/4"	5.25	0.75	2.50	2.50	1.66	2.56	4	0.75	5/8	3.88	5
1 1/2"	6.12	0.81	2.88	2.75	1.90	2.69	4	0.88	3/4	4.50	7
2"	6.50	0.88	3.62	3.31	2.38	2.75	8	0.75	5/8	5.00	9
2 1/2"	7.50	1.00	4.12	3.94	2.88	3.00	8	0.88	3/4	5.88	12
3"	8.25	1.12	5.00	4.62	3.50	3.12	8	0.88	3/4	6.62	15
3 1/2"	9.00	1.19	5.50	5.25	4.00	3.19	8	0.88	3/4	7.25	18
4"	10.00	1.25	6.19	5.75	4.50	3.38	8	0.88	3/4	7.88	25
5"	11.00	1.38	7.31	7.00	5.56	3.88	8	0.88	3/4	9.25	32
6"	12.50	1.44	8.50	8.12	6.63	3.88	12	0.88	3/4	10.62	42
8"	15.00	1.62	10.62	10.25	8.63	4.38	12	1.00	7/8	13.00	67
10"	17.50	1.88	12.75	12.62	10.75	4.62	16	1.12	1	15.25	91
12"	20.50	2.00	15.00	14.75	12.75	5.12	16	1.25	1 1/8	17.75	140
14"	23.00	2.12	16.25	16.75	14.00	5.62	20	1.25	1 1/8	20.25	180
16"	25.50	2.25	18.50	19.00	16.00	5.75	20	1.38	1 1/4	22.50	250
18"	28.00	2.38	21.00	21.00	18.00	6.25	24	1.38	1 1/4	24.75	320
20"	30.50	2.50	23.00	23.12	20.00	6.38	24	1.38	1 1/4	27.00	400
24"	36.00	2.75	27.25	27.62	24.00	6.62	24	1.62	1 1/2	32.00	580

## TECH TUBES & FITTINGS

Phone: +91-22-6743 6862 ; Email: [sales@techtubes.in](mailto:sales@techtubes.in) ; Web: [www.techtubes.in](http://www.techtubes.in)

Information in this catalog was compiled from industry sources that Tech Tubes & Fitting believes to be reliable.  
We, however, do not guarantee the accuracy of this data.

ALL DIMENSIONS IN INCHES