

# ANSI B16.5 Class 300 Slip-On Flanges

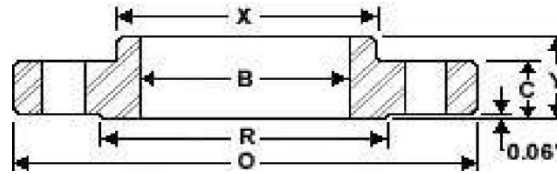

Nominal Size	Outside Diameter O	Thickness C	Dia Of Raised Face R	Dia. Of Hub At Base X	Length Thru Hub Y	Inside Diameter B	No. Of Holes	Dia. of holes	Dia. Of Bolts	Dia. Of Bolt Circle	Approx. Weight (Lbs)
1/2"	3.75	0.56	1.38	1.50	0.88	0.88	4	0.62	1/2	2.62	2
3/4"	4.62	0.62	1.69	1.88	1.00	1.09	4	0.75	5/8	3.25	3
1"	4.88	0.69	2.00	2.12	1.06	1.36	4	0.75	5/8	3.50	3
1 1/4"	5.25	0.75	2.50	2.50	1.06	1.70	4	0.75	5/8	3.88	4
1 1/2"	6.12	0.81	2.88	2.75	1.19	1.95	4	0.88	3/4	4.50	6
2"	6.50	0.88	3.62	3.31	1.31	2.44	8	0.75	5/8	5.00	7
2 1/2"	7.50	1.00	4.12	3.94	1.50	2.94	8	0.88	3/4	5.88	10
3"	8.25	1.12	5.00	4.62	1.69	3.57	8	0.88	3/4	6.62	13
3 1/2"	9.00	1.19	5.50	5.25	1.75	4.07	8	0.88	3/4	7.25	17
4"	10.00	1.25	6.19	5.75	1.88	4.57	8	0.88	3/4	7.88	22
5"	11.00	1.38	7.31	7.00	2.00	5.66	8	0.88	3/4	9.25	28
6"	12.50	1.44	8.50	8.12	2.06	6.72	12	0.88	3/4	10.62	39
8"	15.00	1.62	10.62	10.25	2.44	8.72	12	1.00	7/8	13.00	58
10"	17.50	1.88	12.75	12.62	2.62	10.88	16	1.12	1	15.25	81
12"	20.50	2.00	15.00	14.75	2.88	12.88	16	1.25	1 1/8	17.75	115
14"	23.00	2.12	16.25	16.75	3.00	14.14	20	1.25	1 1/8	20.25	165
16"	25.50	2.25	18.50	19.00	3.25	16.16	20	1.38	1 1/4	22.50	190
18"	28.00	2.38	21.00	21.00	3.50	18.18	24	1.38	1 1/4	24.75	250
20"	30.50	2.50	23.00	23.12	3.75	20.20	24	1.38	1 1/4	27.00	315
24"	36.00	2.75	27.25	27.62	4.19	24.25	24	1.62	1 1/2	32.00	475

## TECH TUBES & FITTINGS

Phone: +91-22-6743 6862 ; Email: [sales@techtubes.in](mailto:sales@techtubes.in) ; Web: [www.techtubes.in](http://www.techtubes.in)

Information in this catalog was compiled from industry sources that Tech Tubes & Fitting believes to be reliable.

We, however, do not guarantee the accuracy of this data.

ALL DIMENSIONS IN INCHES