

ANSI B16.5 Class 2500 Slip-On Flanges

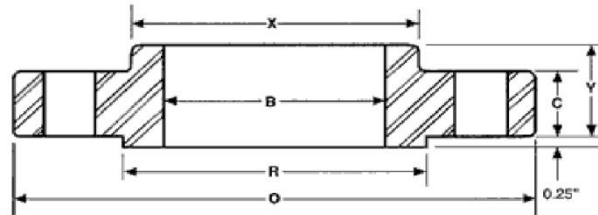

Nominal Size	Outside Diameter O	Thickness C	Dia Of Raised Face R	Dia. Of Hub At Base X	Length Thru Hub Y	Inside Diameter B	No. Of Holes	Dia. of holes	Dia. Of Bolts	Dia. Of Bolt Circle	Approx. Weight (Lbs)
1/2"	5.25	1.19	1.38	1.69	1.56	0.88	4	0.88	3/4	3.50	8
3/4"	5.50	1.25	1.69	2.00	1.69	1.09	4	0.88	3/4	3.75	9
1"	6.25	1.38	2.00	2.25	1.88	1.36	4	1.00	7/8	4.00	13
1 1/4"	7.25	1.50	2.50	2.88	2.06	1.70	4	1.13	1	4.38	20
1 1/2"	8.00	1.75	2.88	3.13	2.38	1.95	4	1.25	1 1/8	4.88	28
2"	9.25	2.00	3.62	3.75	2.75	2.44	8	1.13	1	6.50	42
2 1/2"	10.50	2.25	4.12	4.50	3.13	2.94	8	1.25	1 1/8	7.50	52
3"	12.00	2.63	5.00	5.25	3.63	3.57	8	1.38	1 1/4	8.00	94
4"	14.00	3.00	6.19	6.50	4.25	4.57	8	1.63	1 1/2	9.50	146
5"	16.50	3.63	7.31	8.00	5.13	5.66	8	1.88	1 3/4	11.50	244
6"	19.00	4.25	8.50	9.25	6.00	6.72	8	2.13	2	12.50	378
8"	21.75	5.00	10.62	12.00	7.00	8.72	12	2.13	2	15.50	576
10"	26.50	6.50	12.75	14.75	9.00	10.88	12	2.63	2 1/2	19.00	1068
12"	30.00	7.25	15.00	17.38	10.00	12.88	12	2.88	2 1/2	22.50	1608

TECH TUBES & FITTINGS

Phone: +91-22-6743 6862 ; Email: sales@techtubes.in ; Web: www.techtubes.in

Information in this catalog was compiled from industry sources that Tech Tubes & Fitting believes to be reliable.
We, however, do not guarantee the accuracy of this data.

ALL DIMENSIONS IN INCHES